

TRUMPF TOOLING

Distributed Australia wide by





■ Ketec Precision Tooling Co., Ltd
Manufacturing CNC Punch Tooling



■ Ketec Precision Tooling Co., Ltd
Manufacturing Press Brake Tooling

KETEC CHINA SERVE THE WORLD

The biggest sheet metal tooling manufacturer in China

- National High Tech Enterprise
- Registered Capital: 50 Million RMB.
- Fix Assets: 150 Million RMB.
- Total factory area: 506,000 square feet (47,000 square meters).
- Annual Product Capacity: 1,200,000 sets for CNC punch press tooling; 20,000 sets for Press Brake Tooling.
- Over 300 high-quality employees in the company, KETEC have completed machining, EDM, heat treatment.
- National high-tech enterprise, features sheet metal technology R&D center.
- Obtains 18 national invention and new utility patent.
- Over 10,000 sheet metal enterprises in the world are using KETEC TOOLS
- 24 Direct sales in China and 18 KETEC Agents in the global countries.

1998 Sept. Founded Jiangnan Mold Tools Factory in Guangzhou.
Manufacturing stamping tooling.

2001 Aug. Established Ketec Precision Tooling Co.,Ltd.
Manufacturing CNC punch tooling and stamping tooling.

2004 Feb. Registered **KETEC®** trademark.

2004 Aug. ISO9000:2000 certified.

2004 Nov. Registered **KETEC®** as an international trademark.

2007 Dec. Registered enterprise value increasing to 5 Million RMB.

2008 Jan. Move to Mingzhu Industrial Park in Conghua Guangzhou with
approximately 323,000 square feet (30,000 square meters).

2008 Jan. Registered enterprise value increasing to 10 Million RMB.

2008 Mar. Awarded Guangdong Major Products certificate
for CNC punch tooling.

2008 Jun. Created guideline with permission from Standardization
Administration of People's Republic of China for CNC Turret
Punch Tooling standard.

2010 Feb. Published JB/T 10928–2010, CNC Turret Punch Tooling standard
by China Ministry of Industry and Information.
Implemented in July 2010.

2010 Nov. ISO 9001:2008 Certified.

2011 Jun. Started selling TOP series thick turret tooling.

2011 Nov. Setup warehouse in Taicang Jiangsu.

2012 Mar. Registered enterprise value increasing to 50 Million RMB.

2012 Jul. Rated as National High Tech Enterprise.
Certification No: GR201244000059

2012 Aug. Second location completed in Industrial Nan Road
Conghua Guangzhou with approximately 183000 square feet
(17000 square meters). Manufacturing press brake tooling.

2012 Aug. Established KETEC Precision Tooling Inc. in USA.

2013 Oct. Setup warehouse in Tianjin.

2015 Oct. Honored the Integrity of Law–Abiding business model in Guangzhou.

CONTENTS

**MULTI
TOOLS**

P1-P3

**CARTRIDGE
&
ACCESSORIES**

P10

**MACHINE
GROUPS**

P22

**FULLY GUIDE
SIZE 5 TOOLING
FLAWLESS
WHEEL TOOLS**

P4-P5

**FORMING
TOOLS**

P11-P17

**RP-SERIES
QUICK SET
PU SLITTING
TOOLS**

P6-P7

**SHEET METAL
ACCESORIES**

P18-P19

**PUNCH
DIE
STRIPPER
HEAVY DUTY**

P8-P9

**SHAPE
CLASSES**

P20-P21



MULTI TOOL

Multi-tool 10 STATION

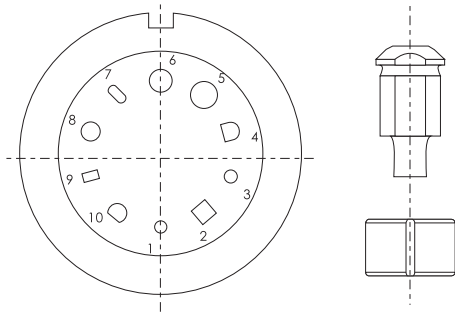

- All punches and dies will be made at 90 deg. Position 1
- Punch Max. Dia: 10.5mm

| Description | Code | Price |
|---------------------------|-----------|-------|
| Punch Ass'y(w/o insert) | TM0.A1 | |
| Basic Body | TM0.P5 | |
| Toothed Wheel | TM0.P6 | |
| Adjusting Key | P.DWZ-TKM | |
| Dowel Pin | TM0.P7 | |
| Screw | P.M10*35A | |
| Dowel Pin | TM0.P8 | |
| Screw | P.M3*8A | |
| Lubrication Vale | P.YB-TKM | |
| Punch Shank | TM0.P9 | |
| Die ass'y(w/o die insert) | TM0.B1 | |
| Die Holder | TM0.D9 | |
| Die Holder w/Brush | TM0.D8 | |
| Brush insert | P.MS8 | |
| Ball | P.GZ-TKM | |
| Screw | P.M6*8F | |

| | | |
|----------------|-----------|--|
| Stripper | TM0.S1 | |
| Pin | P.JX-TKS | |
| Punch Insert | | |
| Round | TM0.P1RO. | |
| Standard shape | TM0.P1**. | |
| Special shape | TM0.P1**. | |
| Die | | |
| Round | TM0.D1RO. | |
| Standard shape | TM0.D1**. | |
| Special shape | TM0.D1**. | |

Multi-tool 4 STATION

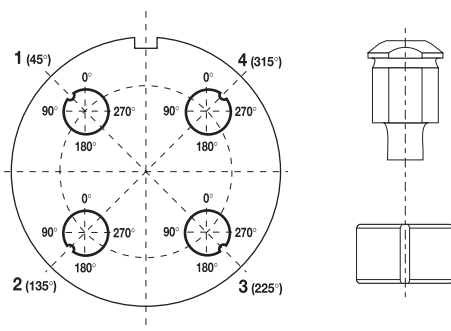

| Description | Code | Price |
|----------------|-----------|-------|
| Punch Insert | | |
| Round | TM4.P1RO. | |
| Standard shape | TM4.P1**. | |
| Special shape | TM4.P1**. | |
| Die | | |
| Round | TM4.D1RO. | |
| Standard shape | TM4.D1**. | |
| Special shape | TM4.D1**. | |

Multi-tool 5 STATION

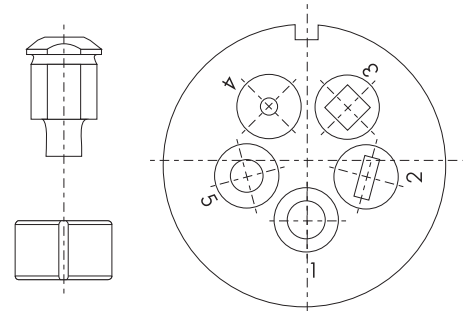

- All punches and dies will be made at 90 deg. Position 1
- Punch Max. Dia:16mm

Multi-tool 6 STATION

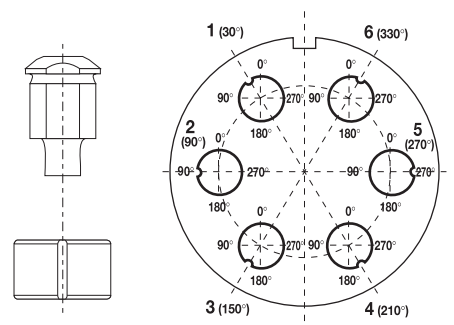

| Description | Code | Price |
|-------------------------|-----------|-------|
| Punch Ass'y(w/o insert) | TM5.A1 | |
| Basic Body | TM5.P5 | |
| Toothed Wheel | TM5.P6 | |
| Adjusting Key | P.DWZ-TKM | |
| Dowel Pin | TM0.P7 | |
| Screw | P.M10*35A | |
| Dowel Pin | TM0.P8 | |
| Screw | P.M3*8A | |
| Lubrication Valve | P.YB-TKM | |
| Punch Shank | TM5.P9 | |
| Die Ass'y(w/o die) | TM5.B1 | |
| Die Holder | TM5.D9 | |
| Ball | P.GZ-TKM | |
| Screw | P.M6*8F | |
| Stripper | TM5.S1 | |
| Pin | P.JX-TKS | |
| Punch Insert | | |
| Round | TM5.P1RO. | |
| Standard shape | TM5.P1**. | |
| Special shape | TM5.P1**. | |
| Die | | |
| Round | TM5.D1RO. | |
| Standard shape | TM5.D1**. | |
| Special shape | TM5.D1**. | |

| Description | Code | Price |
|----------------|-----------|-------|
| Punch Insert | | |
| Round | TM6.P1RO. | |
| Standard shape | TM6.P1**. | |
| Special shape | TM6.P1**. | |
| Die | | |
| Round | TM6.D1RO. | |
| Standard shape | TM6.D1**. | |
| Special shape | TM6.D1**. | |

FULLY GUIDED CUTTING TOOL



1. Special cutting tool with fully guided and enhanced design, longer tool life
2. Max length 28mm [1.10"], Width 1.0–1.5mm [0.04"~0.06"]
3. Max thickness: M.S sheet 1.5mm [0.06"]
4. Heavy Duty die, coating punch available
5. Recommended only for thin sheet metal

SIZE 5 TOOLING



1. For Trumpf group I machine only
2. Max size for Louver: L100mm, W19mm, H6mm [L3.75", W0.75", H0.24"]
3. Max Thickness: Mild Steel 3.0mm [0.12"], Stainless Steel 2.0mm[0.08"]
4. Must setup with special size 5 cartridge
5. Size 5 tooling expand forming dimension to get longer and larger form
Typical solution for Louver / Card Guide / Lance& Form



FLAWLESS CUTTING TOOL

1. Perfect edge quality without nibbling marks
2. No need secondary operations of deburring
3. Punch size 5X76.2 mm [0.19 x 3.00"]
4. Sheet thickness: 0.5~3.0 mm [0.02"~0.12"]
5. Lower overall tooling costs with die blade

WHEEL TOOLS



WHEEL RIB

1. High speed, equal to table travel speed
2. Replaceable wheels, no nibble marks
3. Works under special control program
4. Thickness: 0.8–2.0mm [0.03"~0.08"]
Height: 2~3T.
5. Width: 2H(4–6T). Max. Width: 12.7mm [0.5"]

WHEEL OFFSET

1. High speed, equal to table travel speed
2. Make any shape in auto index station
3. Replaceable wheels, no nibble marks
4. Works under special control program
5. Thickness:
 - Stainless Steel 0.8–1.5mm [0.03"~0.06"]
 - Mild Steel 0.8–2mm [0.03"~0.08"]
 - AL 0.8~2.5mm [0.03"~0.10"]

RP-SERIES

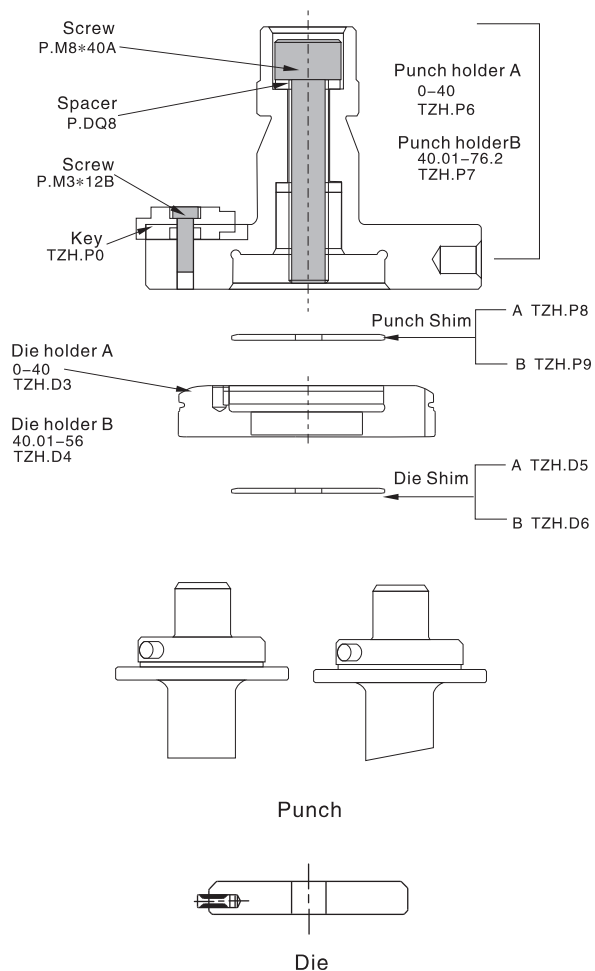

| Description | Code | Price |
|----------------|-------------|-------|
| Punch A1 | 0.77~30.00 | |
| Round | TZH.P1RO. | |
| Standard shape | TZH.P1**. | |
| Special shape | TZH.P1**. | |
| Punch A2 | 30.01~40.00 | |
| Round | TZH.P2RO. | |
| Standard shape | TZH.P2**. | |
| Special shape | TZH.P2**. | |
| Punch B1 | 40.01~56.00 | |
| Round | TZH.P3RO. | |
| Standard shape | TZH.P3**. | |
| Special shape | TZH.P3**. | |
| Punch B2 | 56.01~66.00 | |
| Round | TZH.P4RO. | |
| Standard shape | TZH.P4**. | |
| Special shape | TZH.P4**. | |
| Punch B3 | 66.01~76.20 | |
| Round | TZH.P5RO. | |
| Standard shape | TZH.P5**. | |
| Special shape | TZH.P5**. | |
| Die A | (0.77~40) | |
| Round | TZH.D1RO. | |
| Standard shape | TZH.D1**. | |
| Special shape | TZH.D1**. | |
| Die B | (40.01~56) | |
| Round | TZH.D2RO. | |
| Standard shape | TZH.D2**. | |
| Special shape | TZH.D2**. | |



| Description | Code | Price |
|-----------------------|--------|-------|
| Punch Holder (w/ring) | TQD.P6 | |
| Pin | TQD.P7 | |
| Key | TQD.P8 | |

| | | |
|---------------|-----------------|--|
| Punch Blade A | TQD.P1RE.5/30 | |
| Punch Blade B | TQD.P2RE.5/30 | |
| Punch Blade B | TQD.P2RE.5/56 | |
| Punch Blade B | TQD.P2RE.5/76.2 | |

| Description | Code | Price |
|---------------------|----------|-------|
| Die Holder A | TQD.D6 | |
| Die Holder A w/bush | TQD.D8 | |
| Die Holder B | TQD.D7 | |
| Die Holder B w/bush | TQD.D9 | |
| Screw | P.M4*16A | |
| Bush | P.MS8 | |

| Description | Code | Price |
|------------------|--------------------|-------|
| Solid Blade A | TQD.D1RE.5/30/** | |
| Slitting Blade A | TQD.D2RE.5/30/** | |
| Solid Blade A | TQD.D1RE.5/56/** | |
| Slitting Blade A | TQD.D2RE.5/56/** | |
| Solid Blade B | TQD.D3RE.5/76.2/** | |
| Slitting Blade B | TQD.D4RE.5/76.2/** | |

Note: Max. thickness 3.0mm [0.12"]; Grind life 1.0mm [0.04"]

QUICK-SET TOOL



| Description | Code | Price |
|-------------|-----------|-------|
| PU Blade | | |
| SIZE II -2C | | |
| Punch Ass'y | T2C.P2RE. | |
| Punch | T2C.P9RE. | |
| PU Stripper | T2C.P8 | |

| | | |
|-------------|-----------|--|
| SIZE II -2D | | |
| Punch Ass'y | T2D.P2RE. | |
| Punch | T2D.P9RE. | |
| PU Stripper | T2D.P8 | |

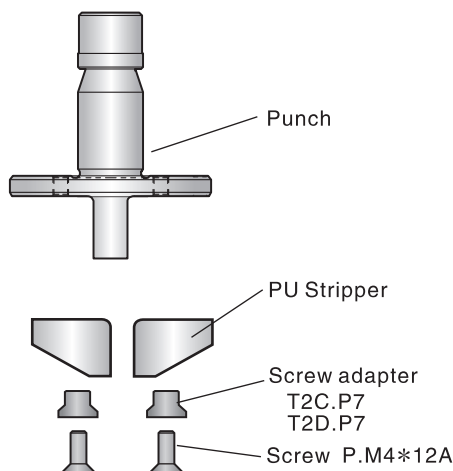

PU SLOTING TOOL



PUNCH(SIZE I / SIZE II)

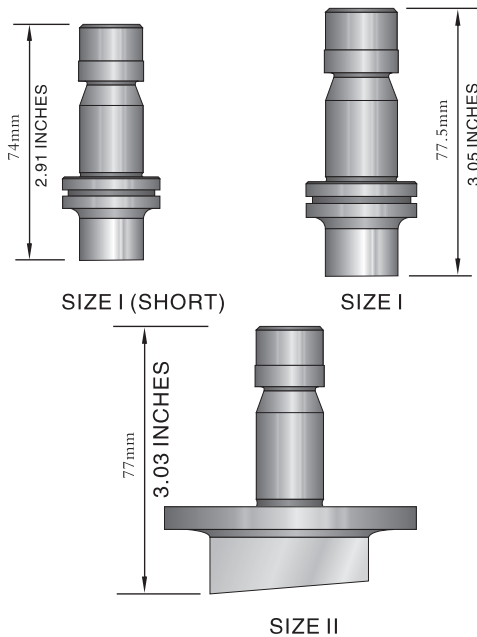

PUNCH CHUNK (SIZE 0A / SIZE0B)

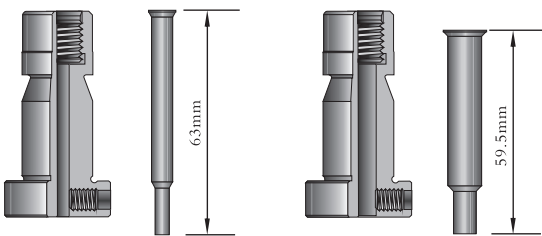

| Description | Code | Price |
|----------------------|---------------------------|-------|
| SIZE 0A | 0.77~6.0mm [0.03"~0.24"] | |
| Punch Chunk | T0A.P9 | |
| Punch Insert (short) | T0A.P1SRO. | |
| Punch Insert | T0A.P1RO. | |
| SIZE 0B | 6.01~10.5mm [0.24"~0.41"] | |
| Punch Chunk | T0B.P9 | |
| Round (short) | T0B.P1SRO. | |
| Shape (short) | T0B.P1S**. | |
| Round | T0B.P1RO. | |
| Shape | T0B.P1**. | |

| Description | Code | Price |
|-----------------------|-----------------------------|-------|
| SIZE I | 10.0~30.0mm [0.39"~1.18"] | |
| Round (short) | T1X.P1SRO. | |
| Standard shape(short) | T1X.P1S**. | |
| Special shape(short) | T1X.P1S**. | |
| Round | T1X.P1RO. | |
| Standard shape | T1X.P1**. | |
| Special shape | T1X.P1**. | |
| SIZE II -2A | 30.01~40.0mm [1.19"~1.57"] | |
| Round | T2A.P1RO. | |
| Standard shape | T2A.P1**. | |
| Special shape | T2A.P1**. | |
| SIZE II -2B | 40.01~50.80mm [1.58"~2.00"] | |
| Round | T2B.P1RO. | |
| Standard shape | T2B.P1**. | |
| Special shape | T2B.P1**. | |
| SIZE II -2C | 50.81~60.0mm [2.00"~2.36"] | |
| Round | T2C.P1RO. | |
| Standard shape | T2C.P1**. | |
| Special shape | T2C.P1**. | |
| SIZE II -2D | 60.01~76.2mm [2.36"~3.00"] | |
| Round | T2D.P1RO. | |
| Standard shape | T2D.P1**. | |
| Special shape | T2D.P1**. | |

DIE

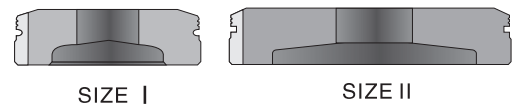

| Description | Code | Price |
|----------------|-----------------------------|-------|
| SIZE I | ~32.00mm [~1.26"] | |
| Round | T1X.D1RO. | |
| Standard shape | T1X.D1**. | |
| Special shape | T1X.D1**. | |
| SIZE II | 32.01~76.20mm [1.26"~3.00"] | |
| Round | T2X.D1RO. | |
| Standard shape | T2X.D1**. | |
| Special shape | T2X.D1**. | |

| Description | Code | Price |
|----------------|----------------------------|-------|
| SIZE I | 10.0~30.0mm [0.39"~1.18"] | |
| Round | T1X.P2RO. | |
| Standard shape | T1X.P2**. | |
| Special shape | T1X.P2**. | |
| SIZE II | 30.01~42.0mm [1.19"~1.65"] | |
| Round | T2X.P2RO. | |
| Standard shape | T2X.P2**. | |
| Special shape | T2X.P2**. | |

| Description | Code | Price |
|----------------|-----------|-------|
| SIZE I | | |
| Round | T1X.D3RO. | |
| Standard shape | T1X.D3**. | |
| Special shape | T1X.D3**. | |
| SIZE II | | |
| Round | T2X.D3RO. | |
| Standard shape | T2X.D3**. | |
| Special shape | T2X.D3**. | |

| Description | Code | Price |
|-------------------|-----------|-------|
| Round (Group H/1) | T1X.S1RO. | |
| Shape (Group H/1) | T1X.S1**. | |
| Round (Group E/F) | T1X.S2RO. | |
| Shape (Group E/F) | T1X.S2**. | |
| Pin | P.JX-TKS | |

| DIE SHIM | Code | Price |
|----------------|-------------|-------|
| SIZE I | | |
| 0.1mm [0.004"] | P.DP-T1XD01 | |
| 0.3mm [0.01"] | P.DP-T1XD03 | |
| 0.5mm [0.02"] | P.DP-T1XD05 | |
| 9 PCS/ PACK | P.DP-T1XD | |
| SIZE II | | |
| 0.1mm [0.004"] | P.DP-T2XD01 | |
| 0.3mm [0.01"] | P.DP-T2XD03 | |
| 0.5mm [0.02"] | P.DP-T2XD05 | |
| 9 PCS/PACK | P.DP-T2XD | |

NOTE: Package with 9 pcs in 3 pcs each thickness

HEAVY DUTY

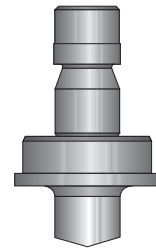

Heavy Duty Punch



Heavy Duty Die

STRIPPER



DIE SHIM



CARTRIDGE & ACCESSORIES

| Description | Code | Price |
|-------------|------|-------|
|-------------|------|-------|

| | | |
|------------------|---------------|--|
| Trumpf Cartridge | J.DJ-T1000 | |
| Alignment Ring | T1X.T1/T2X.T1 | |
| Adaptor | T1X.G1 | |
| Trumpf Die Plate | J.MH-T1 | |
| ≥3 sets(C.D) | J.DJ-MH-T1 | |

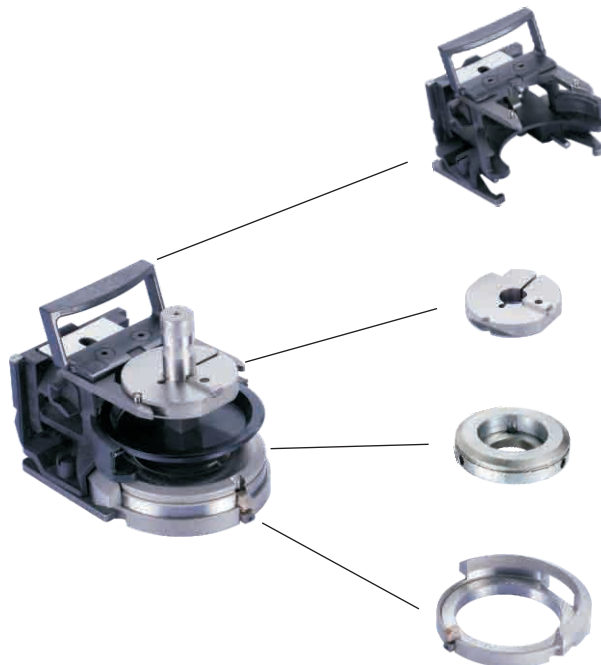

ALIGNMENT RING

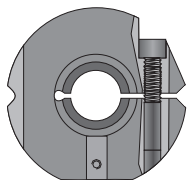

Size I Alignment Ring
(E/F/G/H/1)

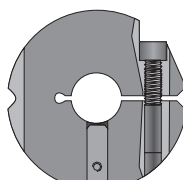

Size II Alignment Ring
(E/F/G/H/1)

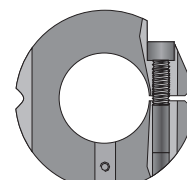

Alignment Ring(HD)

| Description | Code | Price |
|-------------|------|-------|
|-------------|------|-------|

| | | |
|----------------|----------|--|
| Alignment Ring | T1X.T1 | |
| Key | T1X.T9 | |
| Screw | P.M6*35A | |
| Screw | P.M3*12B | |

| Description | Code | Price |
|-------------|------|-------|
|-------------|------|-------|

| | | |
|----------------|----------|--|
| Alignment Ring | T2X.T1 | |
| Key | T1X.T9 | |
| Screw | P.M6*35A | |
| Screw | P.M3*12B | |

| Description | Code | Price |
|-------------|------|-------|
|-------------|------|-------|

| | | |
|----------------|----------|--|
| Alignment Ring | T3X.T1 | |
| Key | T3X.T9 | |
| Screw | P.M6*25A | |
| Screw | P.M4*10A | |

C RING



| Trumpf Machine | Code | Price |
|----------------|------|-------|
|----------------|------|-------|

| | | |
|-----------|------------|--|
| 2000、2020 | J.CH-T | |
| 1000 | J.CH-T1000 | |
| 3000 | J.CH-T3000 | |



■ FORMING TOOLS

KETEC have extensive experience in the design and manufacture of the forming tools, we also have TRUMPF machine, thick turret CNC machine etc., for testing the tooling. We surely can provide the ideal tooling products to you.

Please consult KETEC engineers for questions when customizing the forming tools to your design.

EXTRUSION TAPPING

Prepunch size (Stainless steel) unit: mm [inch]

| Extrusion | | Thickness: T | | | |
|-----------|-------------|--------------|------------|------------|------------|
| Size | øA | 0.6 [0.02] | 0.8 [0.03] | 1.0 [0.04] | 1.2 [0.05] |
| M2.6 | 2.21 [0.09] | 1.3 [0.05] | 1.3 [0.05] | 1.3 [0.05] | |
| M3 | 2.60 [0.10] | 1.3 [0.05] | 1.3 [0.05] | 1.6 [0.06] | 1.8 [0.07] |
| M4 | 3.40 [0.13] | | 2.0 [0.08] | 2.0 [0.08] | 2.0 [0.08] |
| M5 | 4.30 [0.17] | | | 2.3 [0.09] | 2.3 [0.09] |
| M6 | 5.10 [0.20] | | | 3.0 [0.12] | 3.0 [0.12] |

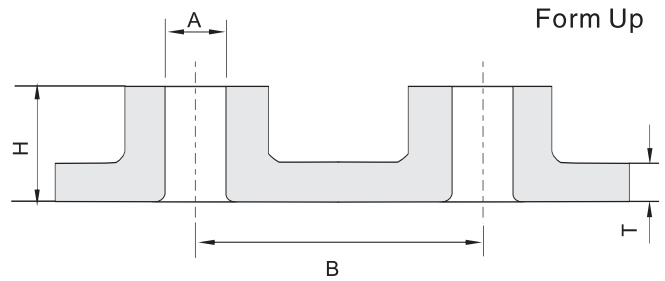

Machine _____ A _____
Material _____ B _____ T _____
H _____

Prepunch size (Mild steel, Aluminum) unit: mm [inch]

| Extrusion | | Thickness: T | | | |
|-----------|-------------|--------------|------------|------------|------------|
| Size | øA | 0.6 [0.02] | 0.8 [0.03] | 1.0 [0.04] | 1.2 [0.05] |
| M2.6 | 2.21 [0.09] | 1.3 [0.05] | 1.3 [0.05] | 1.3 [0.05] | |
| M3 | 2.60 [0.10] | 1.3 [0.05] | 1.3 [0.05] | 1.6 [0.06] | 1.8 [0.07] |
| M4 | 3.40 [0.13] | | 2.0 [0.08] | 2.0 [0.08] | 2.0 [0.08] |
| M5 | 4.30 [0.17] | | | 2.3 [0.09] | 2.3 [0.09] |
| M6 | 5.10 [0.20] | | | 3.0 [0.12] | 3.0 [0.12] |

- Need prepunch
- Give tool enough time to strip
- Replaceable insert design on extrusion
- Form up & Form down
- Max. thickness
Mild steel 2.3mm [0.09"]
AL 2.0mm [0.08"]
Stainless steel 1.2mm [0.05"]

EXTRUSION

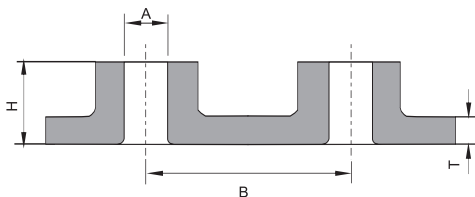

Machine _____ A _____
Material _____ B _____ T _____
H _____

1. Need prepunch
2. Form up & Form down
3. Max. thickness
M.S & AL 2.0mm [0.08"]
S.S 1.2mm [0.05"]
4. Forming Height: $H \geq 2T$



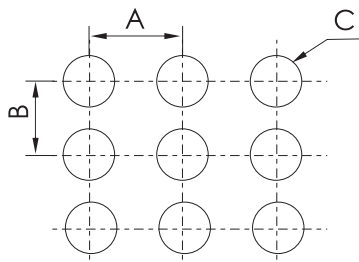

Machine _____ A _____ C _____
 Material _____ B _____ T _____

- Space of holes must be over 3.2mm [0.125"] or 2 x T
- Size 2, code No. T.2X.DK



CLUSTER

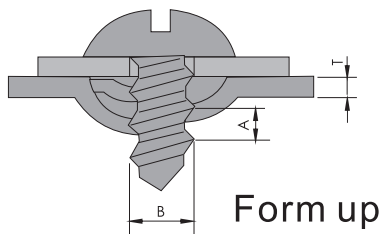

Machine _____ A _____ T _____
 Material _____ B _____



THREAD FORM

- Form up, Form down
- Thickness: 0.5mm ~ 1.2mm [0.02" ~ 0.05"]
- Size 2, code No. form up: T.2S.LW, form down: T.2X.LW

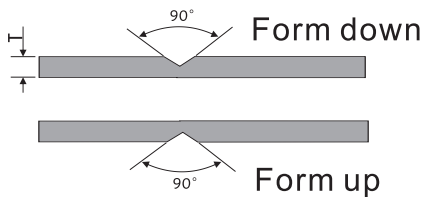

Machine _____ T _____
 Material _____



CENTER POINT

- Forbid punching without sheet
- Adjust the height of the tool to change the depth when punching
- Form up & Form down
- Angle: 90 degree, Max. thickness: 6.0mm [0.236"]

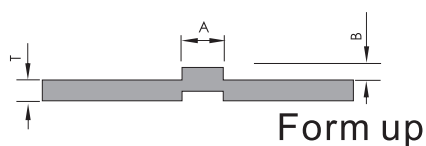

Machine _____ A _____ T _____
 Material _____ B _____

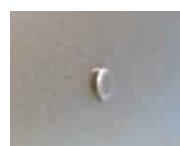

HALF SHEAR

- Form up & Form down
- Max. B size: 0.6 x T

CLOSE LOUVER

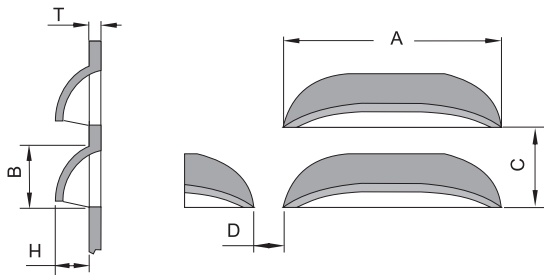

Machine _____ A _____ D _____
 Material _____ B _____ H _____
 C _____ T _____

1. Tooling is made for specific sheet metal thickness
2. Give tool enough time to strip
3. Adjust length without shim, replaceable insert
4. Form up only
5. Size 2, code No.: T.2S.BY

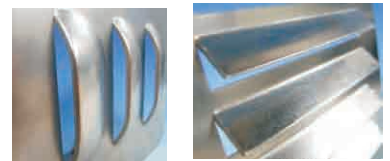

OPEN LOUVER

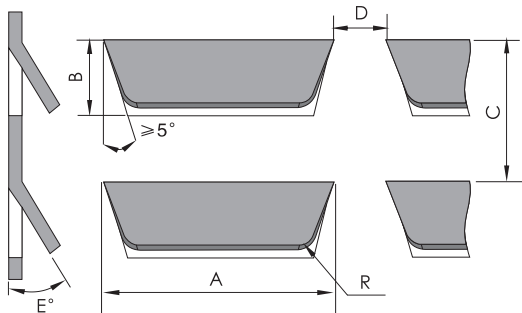

Machine _____ A _____ D _____
 Material _____ B _____ E _____
 C _____ T _____ R _____

1. Tooling is made for specific sheet metal thickness
2. Give tool enough time to strip
3. Consider the moving direction of the material when programing
4. Adjust length without shim, replaceable insert
5. Form up only

CARD GUIDE

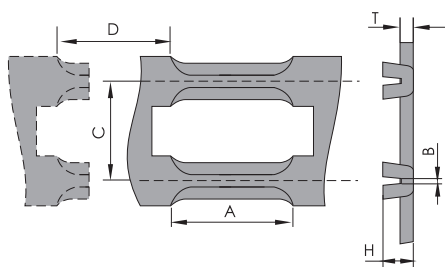

Machine _____ A _____ D _____
 Material _____ B _____ H _____
 C _____ T _____

- Tooling is made for specific thickness
 - Adjust length without shim, replaceable insert
- Forming Height $\leq 2 T$, or will be deformation easily

COUNTERSINK

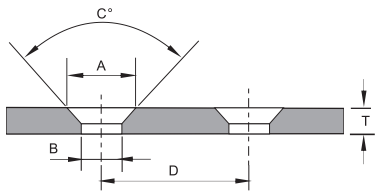

Machine _____ A _____
Material _____ B _____ D _____
C _____ T _____

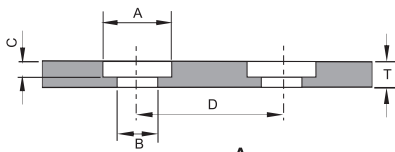

Machine _____ A _____
Material _____ B _____ D _____
C _____ T _____



- Need prepunch
- Adjust prepunch size to get different depth
- Form up & Form down
- Min. thickness: $T \geq 1.0 \text{ mm}$ [0.04"]

EMBOSS COUNTERSINK

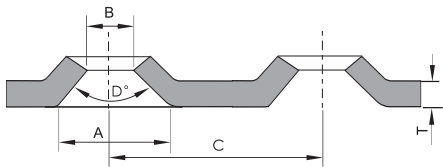

Machine _____ A _____
Material _____ B _____ D _____
C _____ T _____

- Suggest using prepunch
- Form up only

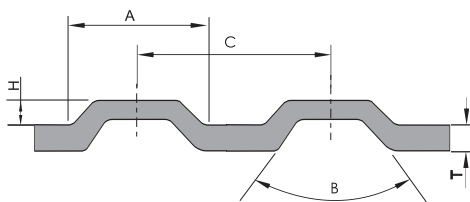

Machine _____ A: _____
Material _____ B: _____ H: _____
C: _____ T: _____

- Escape clamp or punching hole
- Can form in Round or Shape
- Form up & Form down



EMBOSS

THREAD LOOP

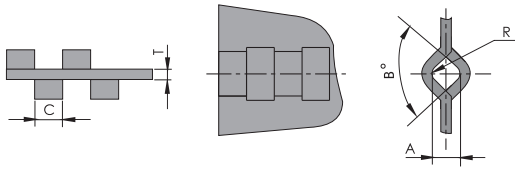

Machine _____
Material _____

A _____
B _____
C _____

R _____
T _____



- Angle B = 90°
- Please fill in the left form

LANCE & FORM

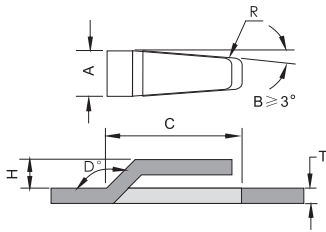

Machine _____
Material _____

A _____
B _____
C _____
D _____

R _____
H _____
T _____



- Tooling is made for specific thickness, can not use thicker material, otherwise the tool will be damaged.
- Please fill in the left form

BRIDGE

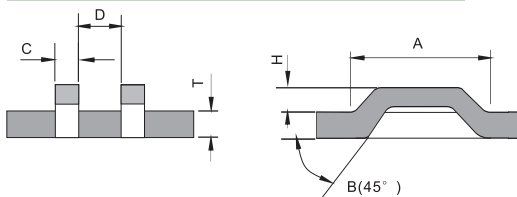

Machine _____
Material _____

A _____
B _____
C _____

D _____
H _____
T _____



- Can be designed in single or double bridge
- Form up & Form down
- Width of the Bridge $C \geq 2T$ and $C \geq 1.8\text{mm}$ [0.07"]

KNOCKOUT

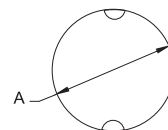

Machine _____
Material _____

A _____
T _____

- For small thickness range only
- Changeable insert for another size, save cost

MULTI-SCRIBE

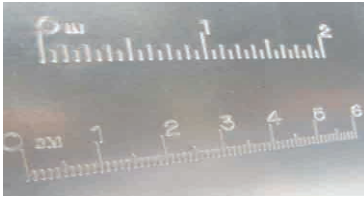

- Forbid punching without sheet
- Required special control program for the machine
- Form down only

STAMPING

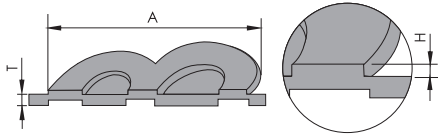
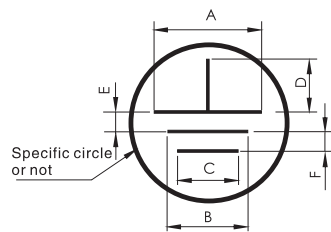

Machine _____ A _____ D _____
 Material _____ B _____ E _____
 C _____ F _____
 G_(width) _____
 H_(depth) _____

Machine _____ A _____ T _____
 Material _____ H _____

- Form up & Form down
- Please fill in the above form

1. Forbid punching without sheet
2. Adjust the height of the tool to change the depth when punching
3. Form up or Form down
4. Please fill in the above form



HINGE

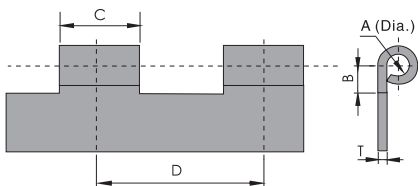

Machine _____ A _____ D _____
 Material _____ B _____ T _____
 C _____

1. Tooling is made for specific sheet metal thickness
2. Need prepunch
3. First for curling, second for forming
4. Form up only
5. Thickness: $T \leq 2.0\text{mm}$ [0.08"] (Mild steel)
 $T \leq 1.5\text{mm}$ [0.06"] (Stainless steel)
6. Please fill in the left form

Trumpf Tools Trolley

Code: J.MJC-TK
Standard configuration

1 Trolley, 3 Shelves, 12 Shelf supports
Full loads 32 sets Trumpf tools



Shelf
J.MJC-TKMK
Each shelf
loads 8 sets Trumpf tools

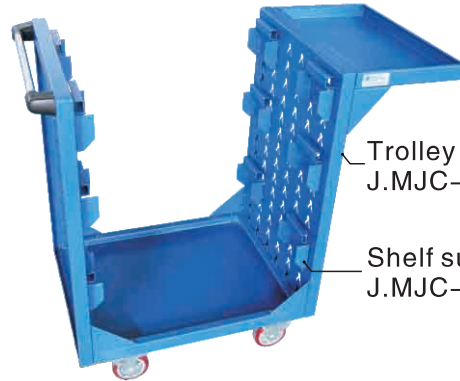

Trolley
J.MJC-CJ
Shelf support
J.MJC-ZJ

Trumpf Tools Cabinet

Code: J.MJG-TK
Standard configuration

Accommodates 1 Trumpf Tools Cabinet, 5 Layers
(Standard: 2SizeI+2SizeII+1Multi-tool)
*Layers are choosable.

5 Layers (2I+2II+1MULTI-TOOL) accommodated
Size I 16 sets PDS, 24 punches, 92 dies
Size II 16 sets PDS, 24 punches, 46 dies
Several punches of MT 5, 10 STN, Size 0A, 0B
Features several Cartridges, Die plates, Adaptors

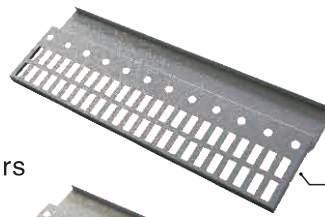

Size I Layer
J.MJG-TKCB1
Capacity:
12 punches+46 dies+8 sets PDS

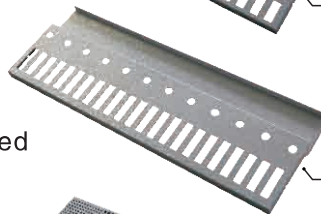

Size II Layer
J.MJG-TKCB2
Capacity:
12 punches+23 dies+8 sets PDS

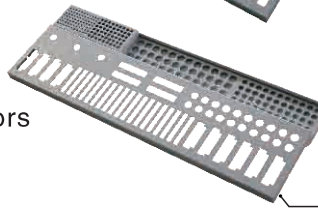

Multi-Tool Layer
J.MJG-TKCB3
Capacity:
MT 5 STN, MT 10 STN, Size 0A, 0B



Trumpf tools cabinet
J.MJG-TKGT



| Code | Price |
|--------|-------|
| J.DZ-1 | |

DEMAGNETIZER

Technical data:

1. Rated voltage: 220V \pm 10% 50HZ
2. Rated current: 3.3A single phase
3. Electrical energy: 1Kw Weight: 6Kg
4. Size (mm): 300X158X230



Auto Tool Grinding Machine Model: AG-135

- Automatic sharpening CNC punch press tools.
- Tool grinding system programs autonomously.
- Precision grinding: \pm 0.005mm.



Basic Parameters

| | | | |
|--------------|-----------|----------|------------------|
| Overall size | L x W x H | Unit: mm | 900 x 800 x 1920 |
| Weight | | Unit: kg | 1100 |
| Voltage | 380V AC | Unit: V | 3-phase / 5-line |
| Max. power | | Unit: KW | 1.75 |

SHAPE CLASSES

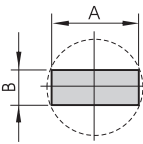
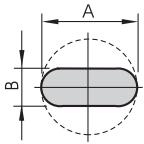
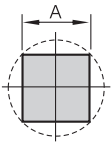
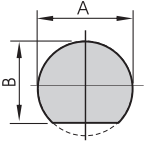
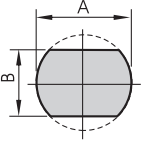
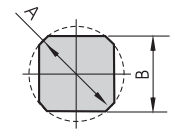
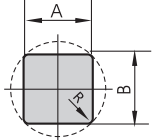
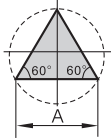
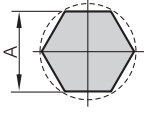
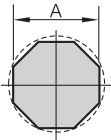
| | | | | | |
|-------------------|---|---|---|--|---|
| STANDARD SHAPE |  |  |  |  |  |
| | Code: RE Name: Rectangle Size: B/A | Code: OB Name: Oblong Size: B/A | Code: SQ Name: Square Size: A | Code: SD Name: Single D Size: B/A | Code: DD Name: Double D Size: B/A |
| |  |  |  |  |  |
| | Code: QD Name: Quad D Size: B/A | Code: QR Name: Quad R Size: B/A/R | Code: ET Name: Equilateral Triangle Size: A | Code: HX Name: Hexagon Size: A | Code: OT Name: Octagon Size: A |

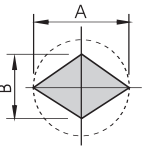
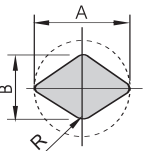
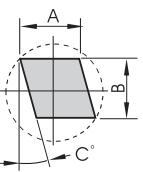
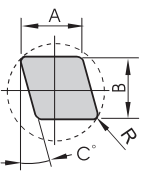
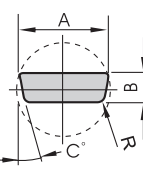
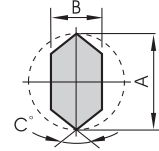
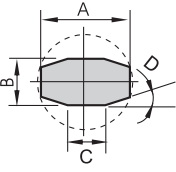
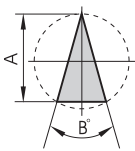
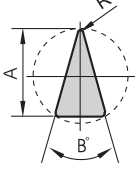
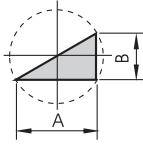
| | | | | | |
|------------|---|---|---|--|---|
| GROUP A |  |  |  |  |  |
| | Code: A0 Name: Diamond Size: B/A | Code: A1 Name: Diamond Size: B/A/R | Code: A2 Name: Diamond Size: B/A/C | Code: A3 Name: Diamond Size: B/A/C/R | Code: A4 Name: Cable Connector Size: B/A/C/R |
| |  |  |  |  |  |
| | Code: A5 Name: Six Edges Size: B/A/C | Code: A6 Name: Eight Edges Size: C/B/A/D | Code: A7 Name: Triangle Size: B/A | Code: A8 Name: Triangle w/R Size: A/B/R | Code: A9 Name: Right Triangle Size: B/A |

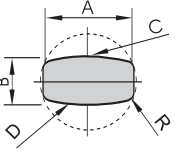
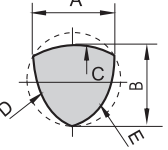
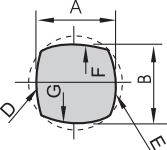
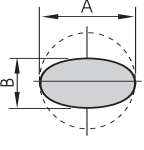
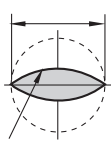
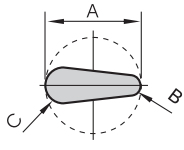
| | | | | | | |
|------------|---|---|---|--|---|---|
| GROUP B |  |  |  |  |  |  |
| | Code: B0 Name: Double R Size: B/A/C/D/R | Code: B1 Name: Tri-R Size: B/A/C/D/E | Code: B2 Name: Quad-R Size: B/A/D/E/F/G | Code: B3 Name: Ellipse Size: B/A/C/R | Code: B4 Name: Football Size: A/B | Code: B5 Name: Key Hole Size: A/B/C |

| | |
|------------------|--|
| SPECIAL SHAPE | Special shape follows the attached drawing |
| | CODE: FT |

SAME STATION TOOLING, SAME GROUP SHAPE, SAME PRICE!

GROUP C

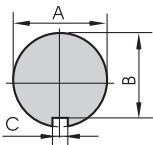
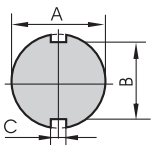
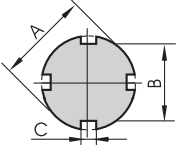
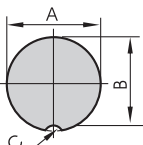
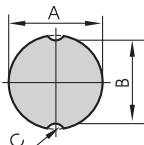
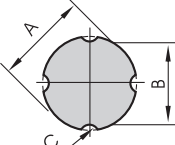
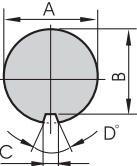
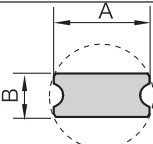
| | | | | | |
|---|---|---|--|---|---|
|  |  |  |  |  |  |
| Code: C0 Name: Key Way Size: C/B/A | Code: C1 Name: Double Key Way Size: C/B/A | Code: C2 Name: Quad Key Way Size: C/B/A | Code: C3 Name: Key Way Size: C/B/A | Code: C4 Name: Key Way Size: C/B/A | Code: C5 Name: Key Way Size: C/B/A |
|  |  | | | | |
| Code: C6 Name: Key Way Size: C/B/A/D | Code: C7 Name: Micro-joint Size: B/A | | | | |

GROUP D

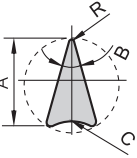
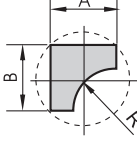
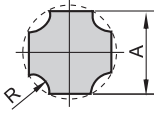
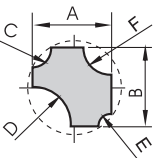
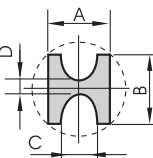
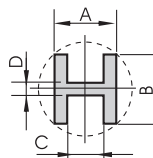
| | | | | | |
|---|---|---|--|---|---|
|  |  |  |  |  |  |
| Code: D0 Name: Triangle w/R Size: A/B/C/R | Code: D1 Name: One way radius Size: B/A/R | Code: D2 Name: Four way radius Size: A/R | Code: D3 Name: Four way radius Size: A/B/C/D/E/F | Code: D4 Name: H w/radius Size: D/C/B/A | Code: D5 Name: H shape Size: D/C/B/A |

GROUP E F

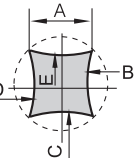
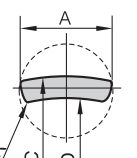
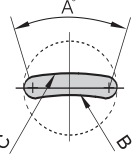
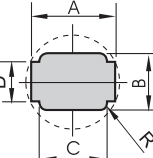
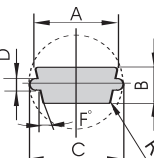
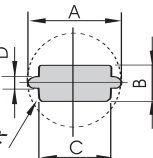
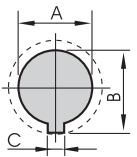
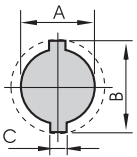
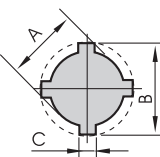
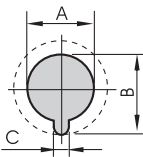
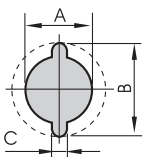
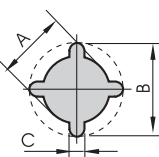
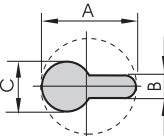
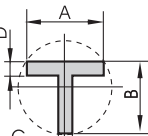
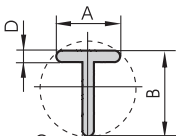
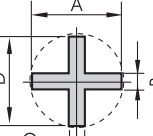
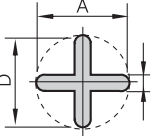
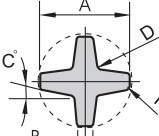
| | | | | | |
|---|---|---|--|---|---|
|  |  |  |  |  |  |
| Code: E0 Name: Four radius Size: A/B/C/D/E | Code: E1 Name: Banana Size: A/C/D/R | Code: E2 Name: Banana Size: B/C/A | Code: E3 Name: Connector Size: D/B/C/A/R | Code: E4 Name: Connector Size: D/B/A/C/F/R | Code: E5 Name: Connector Size: D/B/C/A/R |
|  |  |  |  |  |  |
| Code: E6 Name: Key Hole Size: C/A/B | Code: E7 Name: Key Hole Size: C/A/B | Code: E8 Name: Key Hole Size: C/A/B | Code: F0 Name: Key Hole Size: C/A/B | Code: F1 Name: Key Hole Size: C/A/B | Code: F2 Name: Key Hole Size: C/A/B |
|  |  |  |  |  |  |
| Code: F3 Name: Key Hole Size: B/C/A | Code: F4 Name: T shape Size: D/C/B/A | Code: F5 Name: T shape Size: D/C/A/B | Code: F6 Name: Cross Size: C/B/D/A | Code: F7 Name: Cross Size: B/A/D | Code: F8 Name: Cross Size: B/A/C/D/R |

MACHINE GROUPS

| A | B | C | D | E | |
|--------|---------|----------|----------|-------------|----------|
| CN 700 | CN 901E | CN 1200S | TRUMATIC | SUNIMA T400 | |
| CN 900 | CN 902 | CN 1200A | 20 | TRUMATIC | TRUMATIC |
| CN 701 | CS 75 | CS 15 | 20A | 150K | 202K |
| CN 901 | CS 75.2 | CS 20 | 202M | 151K | 225K |
| | | CS 20 A | | 152K | 235K |
| | | MP25 | | 180K | 300K |
| | | MP25D | | 180.2K | 300LK |
| | | | | 180KD | 300PK |
| | | | | 180LK | 400K |
| | | | | 180.2LK | |

| F | G | H | I | S |
|-----------|----------|----------|------------|-----------|
| 150W | TRUMATIC | TRUMATIC | TRUMATIC | MINIMATIC |
| 152W | 20AW | 500R | 2000R | 100 |
| 180W | 202W | 200R | 2010R | TRUMATIC |
| 180.2W | 300W | 190R | 2020R | 120R |
| 180R | 300LW | 600L | 3000-1300R | 160R |
| 180LW | 300PW | | 3000-1600R | |
| 180.2LW | 300TOP | | 5000R | |
| ELX/SWIFT | 400W | | 6000R | |
| 185 | | | 1000R | |
| 240 | | | | |
| 240R | | | | |
| 250 | | | | |
| 260R | | | | |



| | |
|------------|------------|
| RECIPIENT: | SENDER: |
| COMPANY: | END USER: |
| DEPT.: | TELEPHONE: |
| TELEPHONE: | FAX No.: |
| FAX No.: | PAGES: |
| SUBJECT: | DATE: |

[illegible]



WeChat of KETEC PRECISION TOOLING

More about KETEC PRECISION TOOLING, please enter

[Http://www.ketecool.com](http://www.ketecool.com)



KETEC has certified by the ISO 9001:2008 quality management system

Distributed Australia wide By



Tel: 03 9768 3745

Email: info@punchtech.com.au

www.punchtech.com.au